

# K12 D High Performance Detect Switches

## Features/Benefits

- Overtravel up to 1.4 mm
- Permanent actuation possible
- Designed for low-level switching

## Typical Applications

- Off-road transportation
- Industrial electronics
- Joysticks
- Medical equipment



## Construction

FUNCTION: momentary  
 DISTANCE BETWEEN BUTTON CENTERS:  
 min. 11 (0.433)  
 TERMINALS: PC pins, tinned  
 MOUNTING: Locating pins; K12P additionally with  
 snap-in housing

## Mechanical

TOTAL TRAVEL: 1.5 mm, 2 mm  
 SWITCHING TRAVEL: 0,6 mm \*  
 OPERATING FORCE: 1.5 N OD without snap-point as detector  
 switch

\* Additional switching travel (with pre-travel) available by request

## Packaging

Bulk in boxes of 300 pieces

## Electrical

SWITCHING POWER MIN./MAX.: 0.02mW/3 W  
 SWITCHING VOLTAGE MIN./MAX.: 2 V DC / 30 V DC  
 SWITCHING CURRENT MIN./MAX.: 10 mA /100 mA  
 DIELECTRIC STRENGTH (50 Hz, 1 min): ≥ 500 V  
 OPERATING LIFE with max. switching power: ≥ 10<sup>6</sup> operations  
 CONTACT RESISTANCE: Initial ≤ 50 mΩ  
 INSULATION RESISTANCE: ≥ 10<sup>10</sup> Ω  
 BOUNCE TIME: ≤ 1 ms  
 Operating speed 100 mm/s (3.94/s)

## Environmental

OPERATING TEMPERATURE: -40°C to 85°C.  
 STORAGE TEMPERATURE: -40°C to 95°C.

## Process

SOLDERABILITY:  
 Wave soldering, compatible with lead free soldering profile  
 Hand soldering, 350°C

## Build-A-Switch

To order, simply select desired option from each category and place in the appropriate box. Available options are shown and described on the next page. For additional options not shown in catalog, consult Customer Service Center.

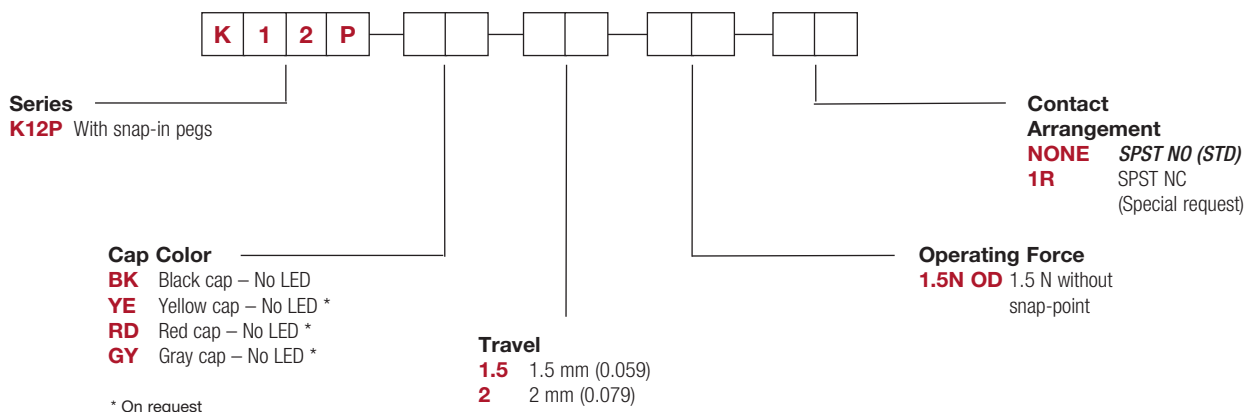

Detect

# K12 D High Performance Detect Switches

## SERIES

**K12P** with snap in

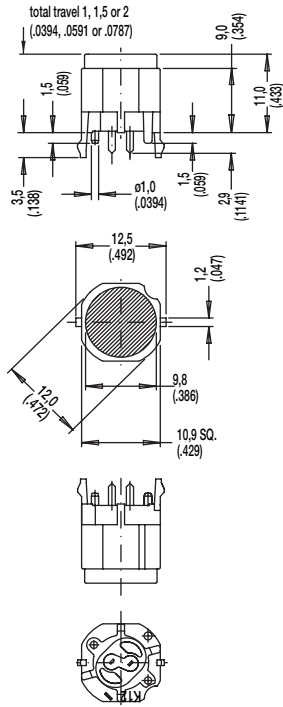

### PCB LAYOUT, MOUNTING SIDE

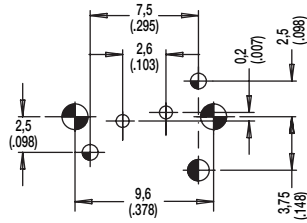

center of actuation area (notice LED)



| Hole | Ø          | Without LED | Description         | Terminal Section        | Surface |
|------|------------|-------------|---------------------|-------------------------|---------|
|      | 1,7 (.069) | 2x          | snap-in             |                         |         |
|      | 1,6 (.062) | 1x          | coding hole (L,M,N) |                         |         |
|      | 1,1 (.043) | 2x          | center hole         |                         | Sn      |
|      | 0,9 (.035) | 2x          | switch              | 0.7 x 0.2 (.028 x .081) | Sn      |