

# PNP Series

## Sealed Pushbutton Switches



### Specifications

Function	SPST, SPDT Double Break (Form Z) Momentary
Contact Arrangement	N.O. and N.C.
Mounting Type	Threaded front mount

**Notes:**

Maximum torque for threaded body: Do not exceed 10 in-lbs (1.35 N-m)

### Mechanical Characteristics

Operating Life	1,000,000 cycles
Total Travel	2 mm max.
Operating Point	0.9 ± 0.25 mm
Over Travel	0.25 mm min.
Operating Force	3N ± 1.5N 8N ± 1.5N
Vibration	10-500 Hz 10g Max.
Shock	50g 11ms sawtooth wave

### Electrical Characteristics

Contact Rating	Option "Q" Silver 5A/32 VDC resistive (25,000 cycles) 3A/32 VDC resistive (25,000 cycles) Option "G" Gold over Silver 10mA/5 VDC resistive (1,000,000 cycles)
Dielectric Strength	1,000 V AC for 1 min.
Insulation Resistance	1 G Ω @ 500 V DC
Initial Contact Resistance	50 mΩ max (without wire leads)
Bounce Time	< 5 ms
Operating Temperature	-40°C to 85°C
ESD Protection	15 KV min.
Sealing	IP68

### Description

The PNP series sealed pushbutton switch is engineered to meet the needs of applications for harsh environments – such as industrial, off-road, heavy equipment and lift products – where the switches are used repeatedly and are exposed to dust, water or other typically damaging elements. PNP switches are IP68 sealed and RoHS compliant, feature a long lifecycle (1,000,000 uses) and are available in a variety of housing styles with up to a 5A resistive load.

### Features & Benefits

- Snap-Action provides positive tactile feedback
- IP68 sealed to endure harsh environments
- 1,000,000 life cycle
- Up to 5A resistive load
- Multiple housing styles
- Various termination types and wirelead options are also available
- RoHS compliant

### Applications

- Control Grips
- Off-Road Panels
- Heavy Equipment
- Industrial Instruments
- Lifts
- Conveyor Controls

### Materials

Housing	PBT/PC
Base	
Cap	PBT
Actuator	
Internal Seal	Silicone rubber
Terminals	Copper with silver nickel inlay, silver plating
Movable Contact	Copper alloy, gold over silver plating
Terminal Seal	Epoxy

**Notes:**

Specifications and materials listed above are for switches with standard options. For information on specific and custom switches, please contact Customer Service.

# PNP Series

## Sealed Pushbutton Switches



### Ordering Number

To order, simply select desired option from each category and place in the appropriate box.

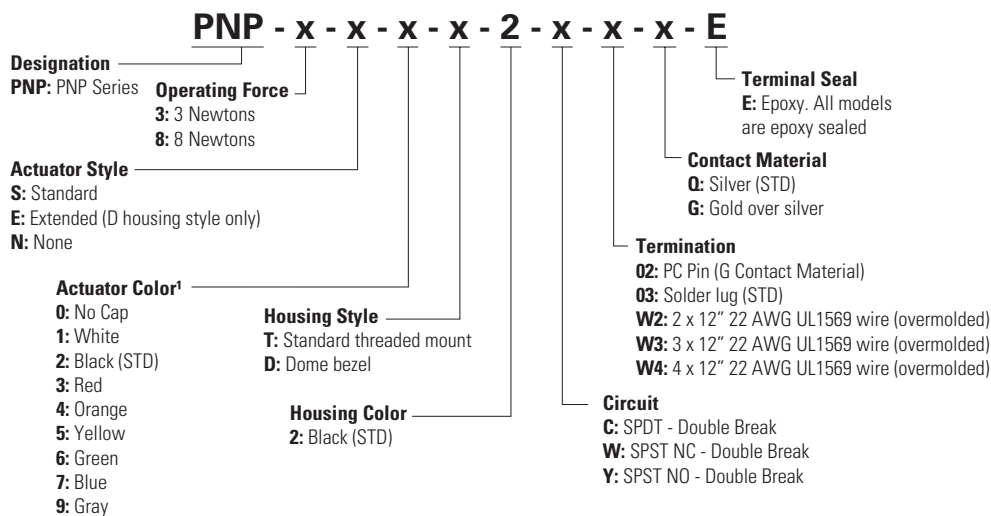

#### Notes:

1. Please contact Customer Service for additional colors.

### Standard View

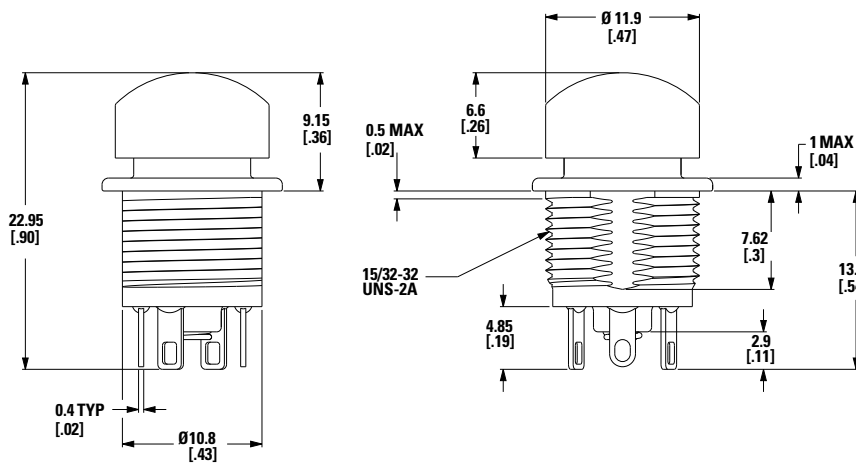

### Electrical Schematic

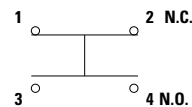

### Operating Force

Option Code	Operating Force
3	3 N
8	8 N

# PNP Series

## Sealed Pushbutton Switches

## Actuator Style

## S Standard

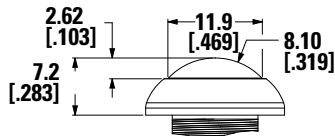

**Scale 3:1**

### E Extended (D Housing Style Only)

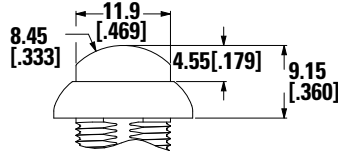

**Scale 3:1**

**N No Cap**

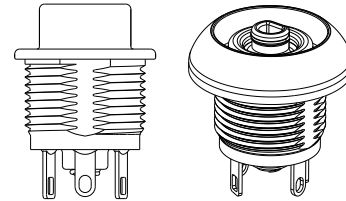

### Actuator Color

Option Code	Actuator Color
0	No Color
1	White
2	Black
3	Red
4	Orange
5	Yellow
6	Green
7	Blue
9	Gray

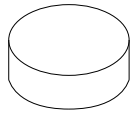

Part Number	Color
285E01000	White
285E02000	Black
285E03000	Red
285E04000	Orange
285E05000	Yellow
285E06000	Green
285E07000	Blue
285E09000	Gray

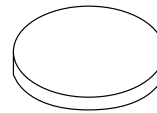

Part Number	Color
824D01000	White
824D02000	Black
824D03000	Red
824D04000	Orange
824D05000	Yellow
824D06000	Green
824D07000	Blue
824D09000	Gray

**Note:** Cap may be ordered separately

## Housing Style

### T Standard Threaded Mount

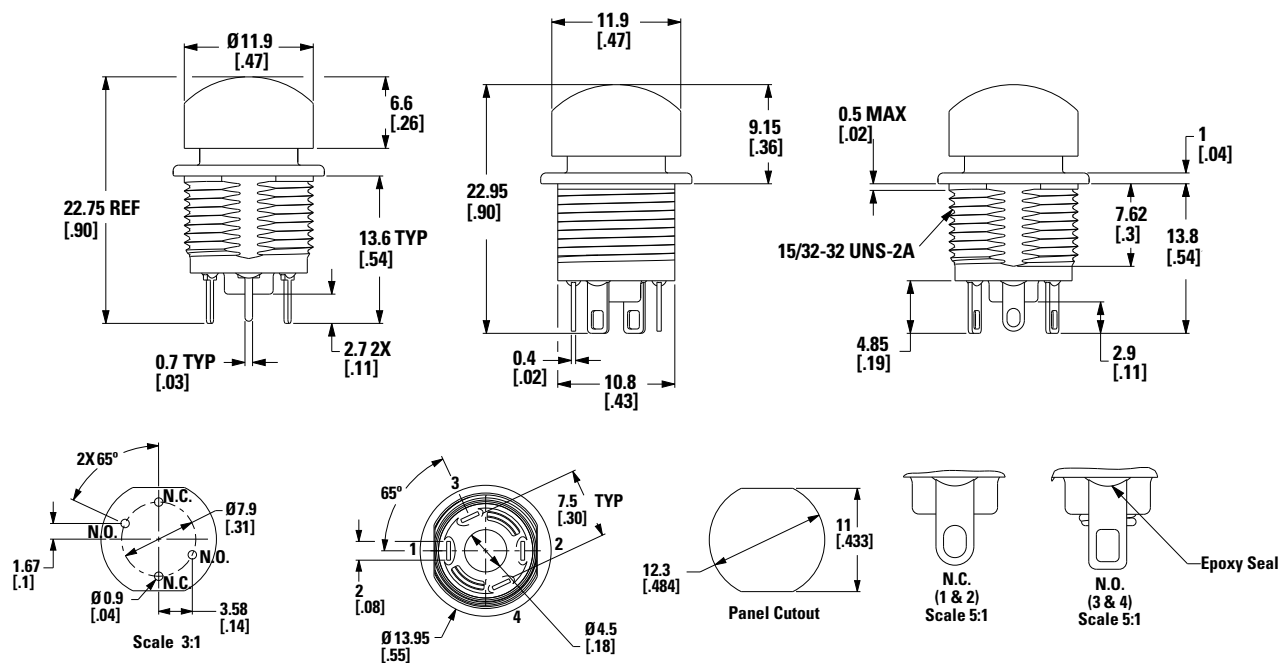

# PNP Series

## Sealed Pushbutton Switches

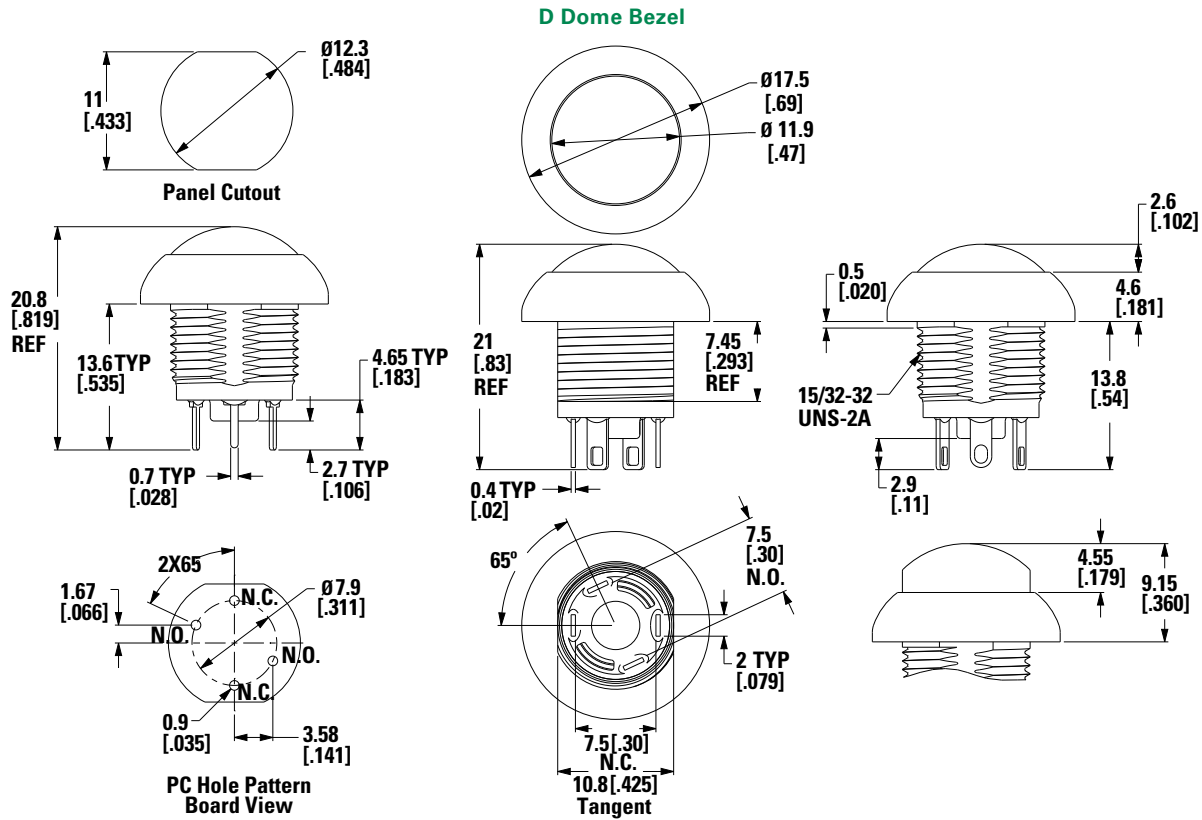

### Housing Color

Option Code	Color
2	Black (STD)

### Circuit

#### W SPST NC - Double Break

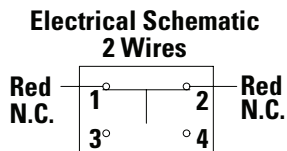

#### Y SPST NO - Double Break

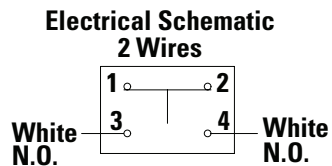

#### C SPDT - Double Break

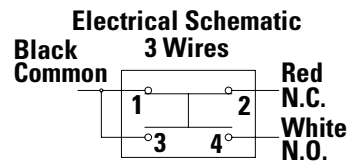

#### C SPDT - Double Break

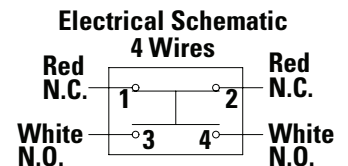

# PNP Series

## Sealed Pushbutton Switches



### Termination

#### 02 PC Pin

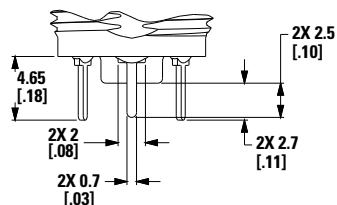

#### 03 Solder Lug (STD)

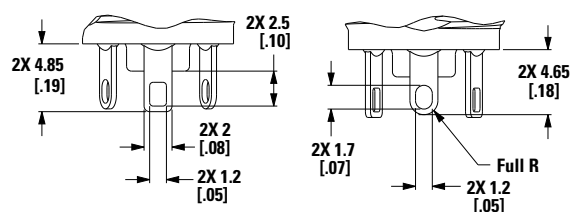

#### W2 2x 12" 22 AWG UL1569 Wire (Overmolded)

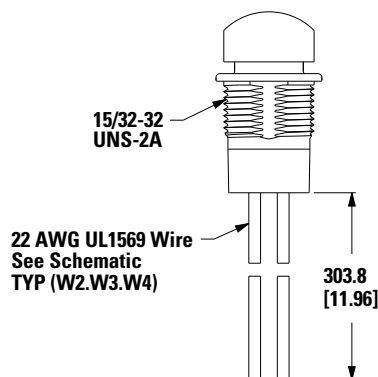

#### W3 3x 12" 22 AWG UL1569 Wire (Overmolded)

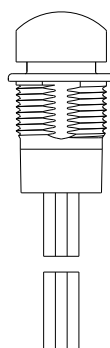

#### W4 3x 12" 22 AWG UL1569 Wire (Overmolded)

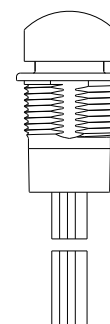

### Contact Material

Option Code	Contact Material
Q	Silver (STD)
G	Gold over silver

### Terminal Seal

**E Epoxy**  
All models are epoxy sealed

### Hardware

#### Hex Nut 707100201 Nickel-Plated

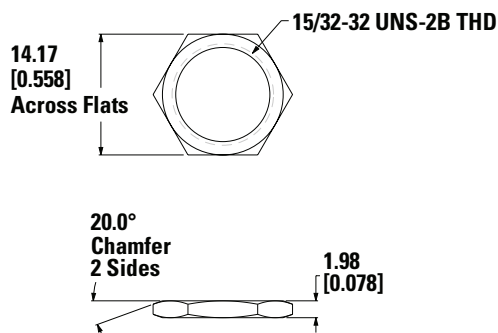

#### Lockwasher 700302202

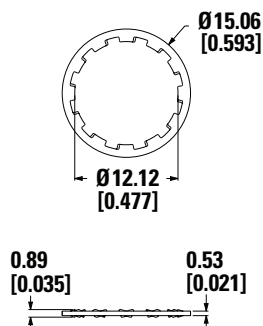

#### Panel Sasket 851D02000

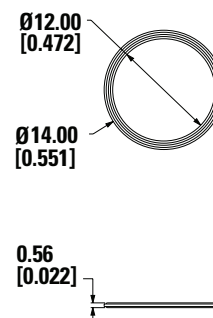

**Disclaimer Notice** - Information furnished is believed to be accurate and reliable. However, users should independently evaluate the suitability of and test each product selected for their own applications. Littelfuse products are not designed for, and may not be used in, all applications. Read complete Disclaimer Notice at <http://www.littelfuse.com/disclaimer-electronics>.