

PTS530 Series

Ultra Low Profile SMT Top Actuated

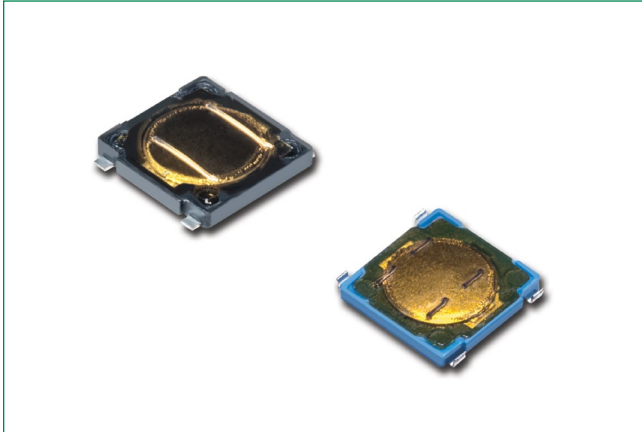

Description

Innovative designers of Bluetooth headsets, MP3 accessories and remote controls turn to the PTS530 series of ultra low profile SMT top actuated tactile switches because of its small footprint and reputation for lasting a high number of cycles. PTS530 switches have a 4.5 x 4.5mm footprint and a thickness of 0.55mm.

Features & Benefits

- 4.5 x 4.5 mm footprint
- 0.55 mm thickness
- High number of cycles
- Symbol line identification

Applications

- MP3 accessories
- Bluetooth headset
- Remote controls
- Garage door opener

Specifications

Function	Momentary action
Contact Arrangement	1 make contact = SPST NO
Terminals	Gullwing for SMT
Travel	0.2mm - 0.1 /+ 0.15mm
Packaging	Switches in reels of 7,000 pieces. Dimensions of reels according to EIA 481B. External diameter 330 mm.

Process

Soldering

This component is suited to the following methods:

Infrared Reflow Soldering in accordance with IEC61760-1

Electrical Characteristics

Max. Voltage	12 VDC
Max. Current DC	50 mA
Dielectric Strength	250 vA C (1mn)
Contact Resistance	≤ 100 mΩ
Insulation Resistance	≥ 100 MΩ
Bounce Time	≤ 10 ms

Environmental Characteristics

Operating Temperature	-40°C to 85°C
------------------------------	---------------

PTS530 Series

Ultra Low Profile SMT Top Actuated



Mechanical Characteristics

Item Description	Operation Force (gf)	Operating Life (operations)
PTS530 GN055 SMTR LFS	100 ± 30	1,000,000
PTS530 GM055 SMTR LFS	160 ± 30	1,000,000
PTS530 GH055 SMTR LFS	200 ± 30	200,000
PTS530 GK055 SMTR LFS	260 ± 30	200,000
PTS530 GG065 SMTR LFS	400 ± 70	300,000
PTS530 GS065 SMTR LFS	600 - 50/+100	150,000

Notes:

Specifications listed above are for switches with standard options. For information on specific and custom switches, consult Customer Service Center. The PTS series is not certified for using in Automotive application and no PPAP. However, in the case of some automotive accessories and specific applications for 2 and 3 wheeled vehicles the PTS is widely used and very suitable. Please contact your local representative to discuss your application and the best switch solution.

Termination G Gullwing

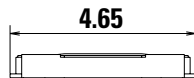

Body Type & Actuation Force

055 0.55 mm height

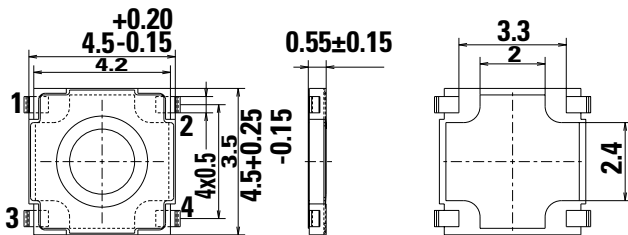

065 0.65 mm height

Part Number	HEIGHT
PTS 530 GS 065 SMTR LFS	0.72
PTS 530 GG 065 SMTR LFS	0.68

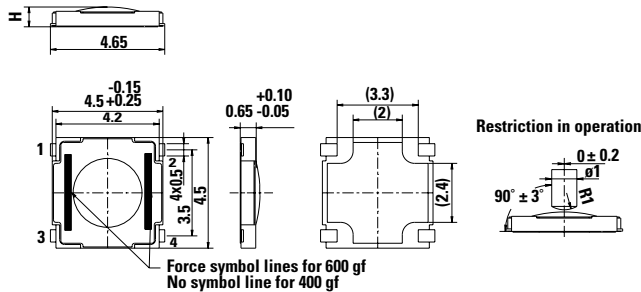

Actuation Force Identification Lines Schematic

Alternative PCB Layout

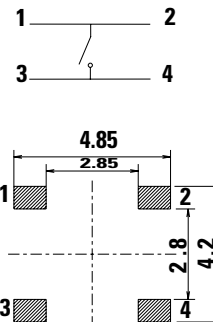

Recommended PCB Layout

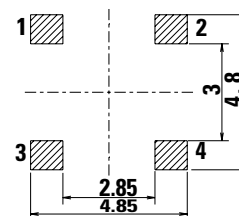

PTS530 Series

Ultra Low Profile SMT Top Actuated



Actuation Force Identification

N: 100 GF	
M: 160 GF	No Lines
H: 200 GF	
K: 260 GF	
G: 400 GF	No Lines
S: 600 GF	

Tape & Reel

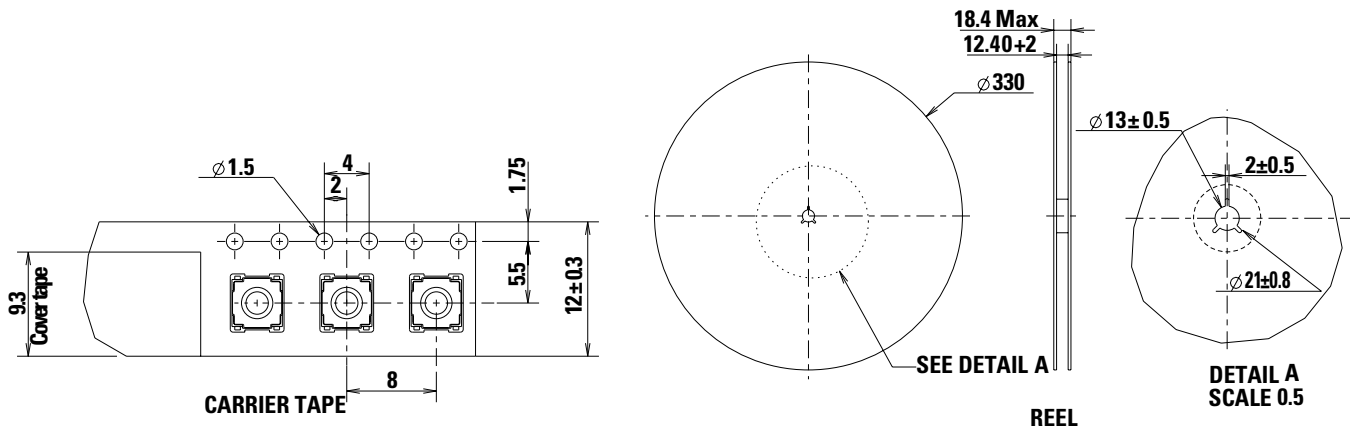

Ordering Number

Our easy build-a-switch concept allows you to mix and match options to create the switch you need. To order, select desired option from each category and place it in the appropriate box. For any part number different from those listed above, please consult your local representative.

PTS530 - G - x - xxx - SMTR - LFS

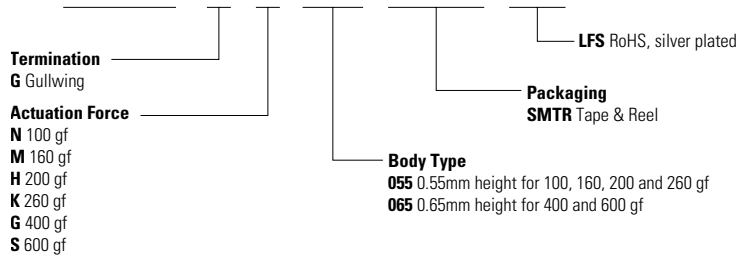

Liability Limitation

This datasheet does not provide enough information for applications that require a certain level of quality or safety such as automotive, medical systems, or safety equipment. Please contact customer service for the contractual specification package.

Disclaimer Notice - Information furnished is believed to be accurate and reliable. However, users should independently evaluate the suitability of and test each product selected for their own applications. Littelfuse products are not designed for, and may not be used in, all applications. Read complete Disclaimer Notice at <http://www.littelfuse.com/disclaimer-electronics>.